

**Save the Date: September 15 & 16, 2011**  
**To Infinity ... and Beyond Waste**

Full Program Information coming soon.

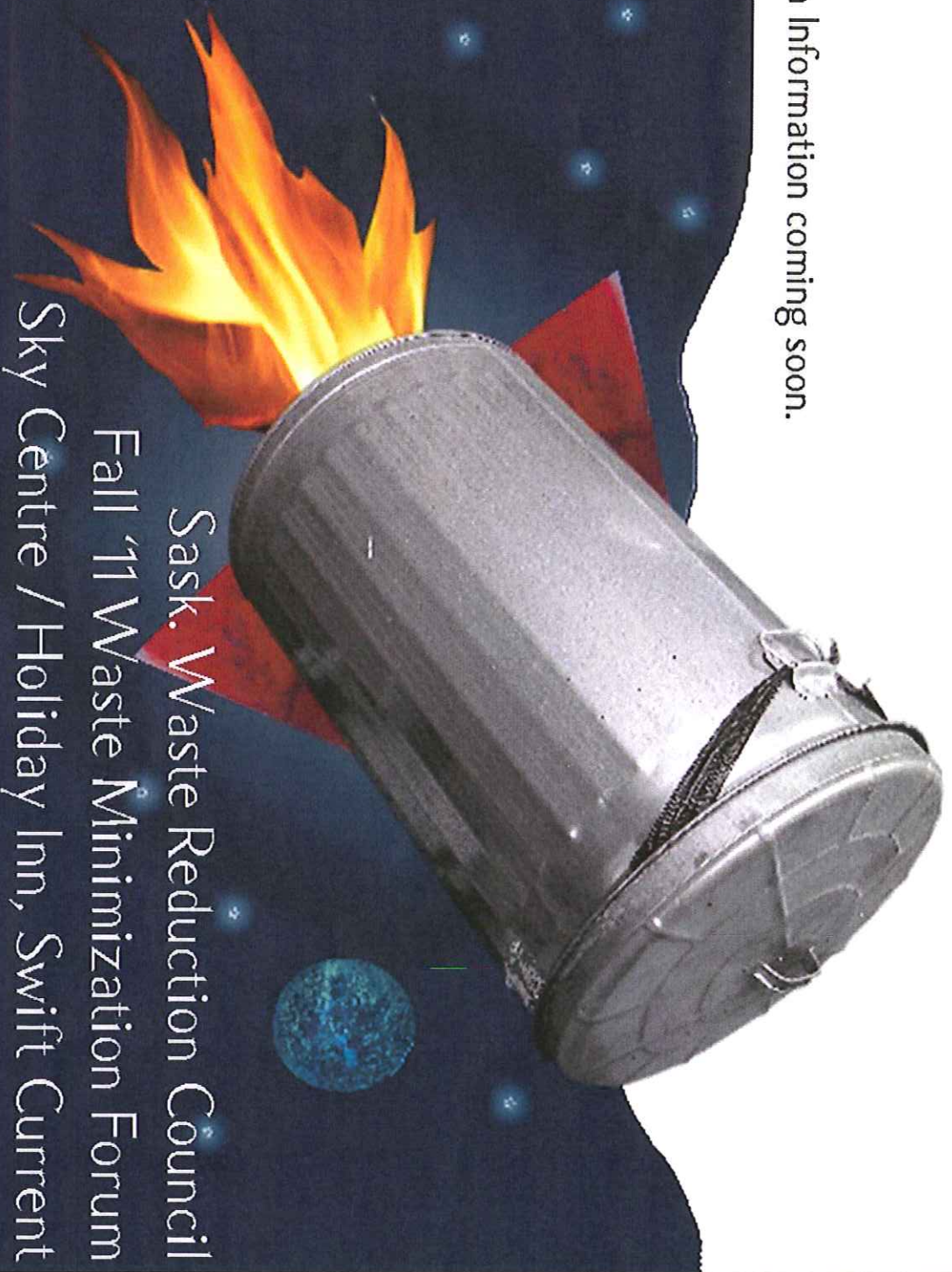

Sask. Waste Reduction Council  
Fall '11 Waste Minimization Forum  
Sky Centre / Holiday Inn, Swift Current



Ministry of  
Municipal  
Affairs

Community Planning

420 – 1855 Victoria Avenue  
Regina, Saskatchewan S4P 3T2  
(306) 787-2762  
(306) 798-0194 (fax)

June 29, 2011

File: T0156-11R  
Your File: R-0011-11

Larry McLeod, SLS, P. Surv.  
Midwest Surveys Inc.  
405 Maxwell Crescent  
REGINA, SK S4N 5X9

RECEIVED  
JUL 07 2011

Dear Mr. McLeod:

**RE: Town of White City  
N ½ 13-17-18 W2M  
Proposed Residential Subdivision**

Following up with our previous correspondence and emails regarding the above proposed subdivision, our office has now received comments from most of agencies contacted. However, before we are able to make a final decision this office requires resolution of the following issues:

- As previously mentioned Saskatchewan Environment had concerns with the capacity of the existing lagoon that serves the Town of White City and surrounding areas. No new subdivisions will be approved in the Town of White City until a new sewage lagoon.
- The Town of White City in their letter dated April 28, 2011 indicated the Town is currently undertaking a project to expand the wastewater capacity of their current lagoons. We require confirmation from Saskatchewan Environment once the sewage lagoons have been upgraded and have capacity for this subdivision.
- The proponent must sign a Servicing Agreement with the municipality. This office required a signed copy of the Servicing Agreement and confirmation of settlement of any required fees before we can make a final decision.

Please call me if you have any questions about your application.

Larry McLeod, SLS, P. Surv.  
Page 2  
T0156-10R  
June 29, 2011

---

Sincerely,

  
Mauricio Jiménez  
Planning Consultant

cc: **Town of White City**  
Great Plains Leaseholds Ltd. Suite 30-28 Great Plains Road EMERALD PARK  
SK S4L 1B8



Ministry of  
Corrections, Public  
Safety and Policing

Deputy Minister

1200 - 1874 Scarth Street  
Regina, Canada  
S4P 4B3

(306) 787-8065  
(306) 798-0270 Fax

June 9, 2011

RECEIVED  
JUL 04 2011

- All Municipal Locations within the RCMP Cost Redistribution Program.

Dear Mayor or Reeve:

I am writing to advise you of the 2011 rates for RCMP services for your community.

I can advise there is no change in the per capita rate for 2011. The 2006 population census figures will again be used to calculate the exact cost that will be charged to your municipality for RCMP policing this year. The attached information provides background on the program and rates for 2011.

The RCMP has advised that Detachment Advisory Committees are established throughout the Province. We support and encourage all communities to work closely with their local RCMP detachment members to ensure a satisfactory level of policing services is provided and the overall priorities of the communities within the detachment area are met.

You can expect to receive your invoice sometime this summer. If you have any questions, please feel free to contact Mr. Trevor Wowk, Director of Financial Services, Policing Services Division at (306) 787-8608 or via email at [Trevor.Wowk@gov.sk.ca](mailto:Trevor.Wowk@gov.sk.ca)

Sincerely,

Al Hilton  
Deputy Minister

Attachment

cc: Trevor Wowk, Director of Financial Services, Policing Services Division,  
Ministry of Corrections, Public Safety and Policing



## RCMP COST REDISTRIBUTION PROGRAM - 2011

### *What are the new rates?*

The following table shows the per capita rates that have been set for 2011.

Category	2011 Per Capita Rates
Urban municipalities with RCMP detachments	\$52.45
Urban municipalities without RCMP detachments	\$32.45
All Rural Municipalities	\$32.45

### *Background*

In 2011, the Government will spend approximately \$149.7 million for RCMP policing in Saskatchewan, recovering approximately \$14 million from municipalities through the RCMP Cost Redistribution Program. This program is designed to provide quality cost-effective policing for rural residents and residents of communities with a population of less than 5,000. It is premised on the principle that every municipality contributes to its policing cost.

In 2006, two rates were established, one for municipalities with an RCMP detachment and one for municipalities without a detachment. There is a \$20.00 differential between the two rates. Community leaders have expressed the view that a community with a detachment receives more benefit than a community without a detachment and that rates should be based on that factor.

In 1995, in partnership with representatives from SUMA and SARM, the Government formed the *SUMA/SARM Task Force on Policing and the Administration of Justice*. The formation of the Task Force was a direct result of many municipalities asking for changes in the way police costs were recovered. The method at that time was viewed by many as unfair because urban municipalities with populations over 500 were faced with high policing costs while urban municipalities under 500 and rural municipalities were not required to pay for policing.

The objective of the Task Force was to find an equitable and fair way to allocate RCMP municipal police costs to relieve the financial burden some communities were facing. Over the following three years, the Task Force considered many options and agreed on the formula adopted by the Government in 1999. In establishing the pool, it was understood that the contributions of the participants would pay the entire costs for policing the communities in the pool.

Data from the **2006 population census** will be used to calculate the total cost for RCMP Cost Redistribution in 2010 for each municipality. Even though the per capita rate remains constant this year, the amount of your invoice may be different from your 2010 invoice if a municipality provides administrative support to the local RCMP detachment in accordance with the terms of the Municipal Policing Agreement an individual community has established with the federal government.

The following table shows the impact of the rate change for each category of municipality, including the percentage change for each category and how the cost distribution changes from 2010 to 2011.

Category	2010 Rates	2011 Rates	% Change in Per Capita Rates from 2010 to 2011
Urban Municipalities with RCMP Detachments	\$52.45	\$52.45	0 %
Urban Municipalities without RCMP Detachments	\$32.45	\$32.45	0 %
All Rural Municipalities	\$32.45	\$32.45	0 %

***For more information contact:***

Trevor Wowk  
Director of Financial Services  
Policing Services Division  
Ministry of Corrections, Public Safety and Policing  
1850 - 1881 Scarth Street  
REGINA SK S4P 4K9  
Phone: (306) 787-8608  
Fax: (306) 787-0136  
Email: [Trevor.Wowk@gov.sk.ca](mailto:Trevor.Wowk@gov.sk.ca)



# White City Emerald Park K-9 School

June 27, 2011



# White City Emerald Park K-9 School

June 27, 2011

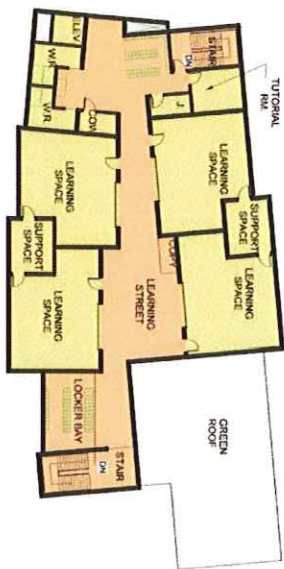

# White City Emerald Park K-9 School

June 27, 2011